

Canvas Student Instructional Impacts (SII) Connector

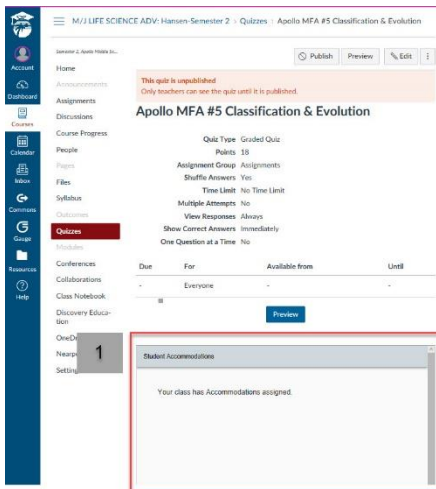

Overview SII

SII is a connector embedded in Canvas Announcement, Discussion, Assignment and Quiz pages. SII displays accommodations for all students with an IEP in the course. IEP accommodations are displayed within Canvas to make it as easy as possible for teachers to develop differentiated content based on their student's needs.



There are two views of SII, one while in **1** View mode of a Canvas page, and the other when in **2** Edit mode. The View mode does not display any student proprietary information to allow using Canvas in the classroom. The Edit view mode is for the teacher and provides a detailed list of the students and their accommodations.

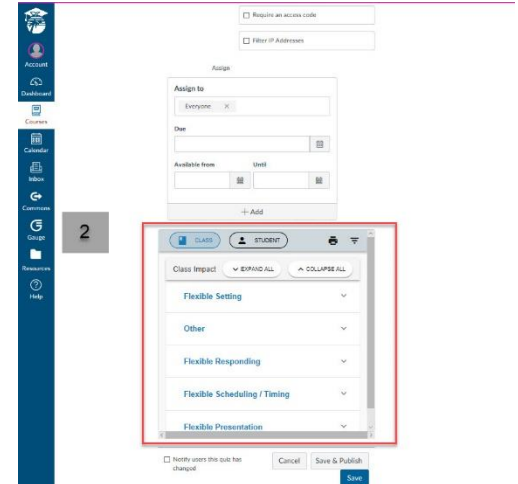

When in the **2** Edit mode, SII will display details about the accommodations of students in your course.

Notice the **Class** and **Student** followed by the **Print Class View**

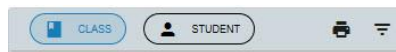

buttons in SII's top navigation bar, report and **Filter** buttons

Notice the **Class** button which displays a view of impact groups (Flexible Responding) with those type of accommodations expanded below.

Expand ▾ an accommodation to view all the students in the course with this accommodation.

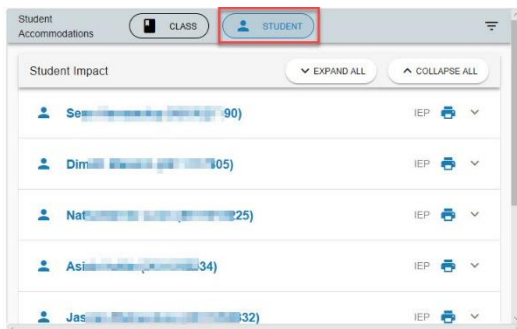
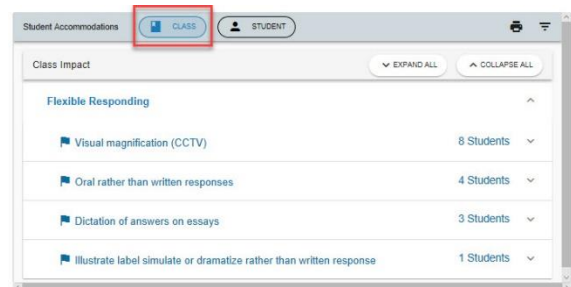

Notice the **Student View** button. When clicked the view will change to arrange by student, rather than impact, and from there you can drill into the accommodations of each student